

Food Grinder Attachment

A:Grind Worm

E:Locking Ring

B:Ginder Body

F:Food Tray

C:Grinding Blade

G:Food Pusher

D:Grinding Plate

H:Kidney Grind Plate

To Assemble Food Grinder Attachment (FGA)

- 1.Insert the grind worm(A) into the grinder body (B).
- 2.Place the grinding blade (C) over the square shank at the exposed end of the grind worm. Make sure blade in correct direction as shown above~ Sharp edge facing outside
- 3.Place grinding plate (D) or (H) over the blade,matching the tabs of thie plate with the notches of the grinder body.
- 4.Place locking ring (E) on grinder body,turning by hand until secured but not tightened.
- 5.Place the Tray (F) into the body
- 6.Combination food pusher (G) is used to feed food into the hopper.
- 7.Kidney Shape Plate(H) is ideal for sausage stuffing with staffer tube.

Install blade sharp side outward!!!

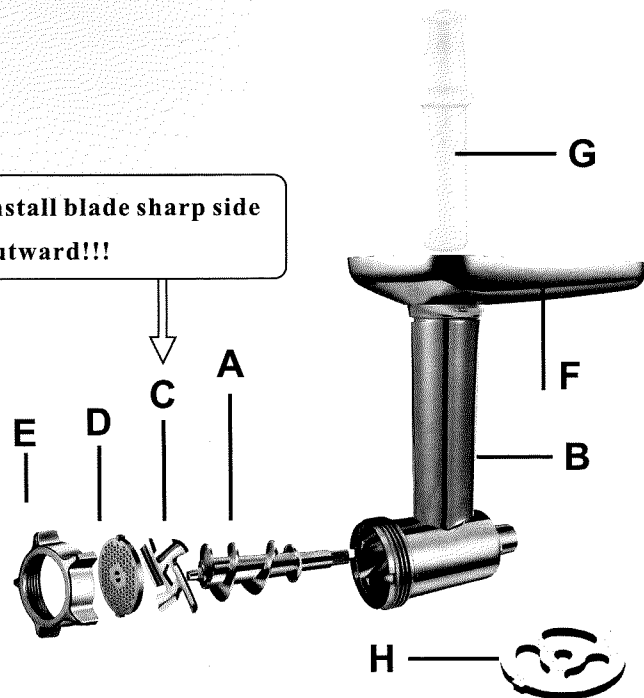

TO Use Food Grinder Attachment

! WARNING



Rotating Blade Hazard

Always use Food pusher.

Keep fingers out of openings.

Keep away from children.

Failure to do so can result in amputations or cuts.

Coarse Plate – Idea for grinding raw or cooked meats ,firm vegetables dried fruits and cheese.

Medium Plate – Idea for grinding raw meat,cooked meats for spreads and breadcrumbs.

Fine Plate – Idea for grinding meat for fine grind for casing and curing or raw meat without fat,no any tendons.

Grinding Meat –For better mix and more tender results.grind beef twice. Best texture results from grinding very cold or partially frozen meat. Frozen fatty meats should be ground only once.Recommend less fatty.

Grinding Bread –To grind bread for crumbs, be sure that bread is either oven dried thoroughly to remove all moisture,or not dried at all. Partially dried bread may jam the Food Grinder.

NOTE:Very hard ,dense foods such as totally dried homemade bread should not be ground,Homemade bread should be ground fresh and then oven or air –dried.

TO Use Food Grinder Attachment

- 1.Cut food into small strips or pieces and feed them into hopper. Meat should be cut into long narrow strips/ cubes.
- 2.Turn mixer to Speed 4 and feed food into hopper using the food pusher.

Sausage Stuffer Attachment

With additional accessories-Sausage Stuffer Tube,FGA can become a Sausage Stuffer Attachment.

To Assemble Sausage Stuffer Attachment:

- 1.Insert grind worm(A)into the grinder body(B).
- 2.Place the retainer bar(C) over the square shank at the exposed end of the grind worm.
- 3.Insert desired Sausage Stuffer tube(K)in ring (L) and then screw onto grinder body,turning by hand until finger tight,but not over tightened.

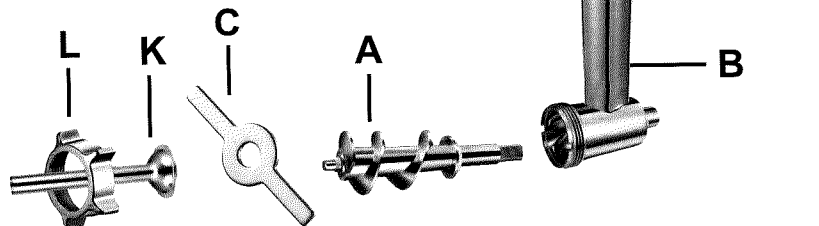

Assembly sequence as below picture -Grind Worm(A), Two side grinding Blade(I),Kidney Grind Plate (H). Stuffer Tube(K) and Locking Ring(L)

Highly recommend following steps to stuff sausage:

No Need to Grind Meat double times, Only One Time!Form girding meat directly to stuffing sausage at the same time .

- 1.Cut raw meat to short narrow cubes
- 2.Mix Sausage seasonings and other ingredients together with the cut meat (from 1st step)

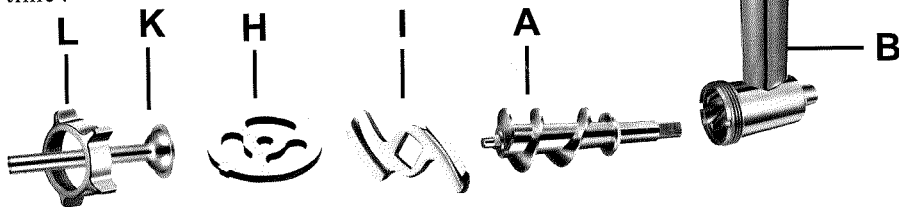

- 3.Freeze the Mixed meat with seasonings (from 2nd step)for a while,or just put it aside for a few minutes to let water drained.
- 4.Then put the waterless or partially frozen meat on food tray to stuff sausage directly.

PROPERTY OF



BRAZORIA COUNTY
LIBRARY SYSTEM

<http://bcls.lib.tx.us>

Kitch  **c**

Food Grinder Attachment

IMPORTANT SAFEGUARDS

When using this attachment, basic safety precautions should always be followed including the following:

1. For operation of stand mixer, refer to its operation instruction when you bought machine from its related sellers.
2. Close supervision is necessary when any appliance is used by or near children.
3. Avoid contacting moving/rotating parts.
4. Do not use the mixer outdoors. This product is designed for household use only.
5. Never feed food by hand. Always use combination food pusher.
6. Blades are sharp. Handle carefully.
7. Never leave your food grinder attachment unattended while the stand mixer is running.

TO Clean Food Grinder Attachment

First completely disassemble food grinder attachment.

Recommend Hand Wash for all FGA parts.

Following parts are Not Dishwasher Safe! Do not wash in Dishwasher! Wash by Hand. Suggest putting all parts in warm, sudsy water for a few minutes, then clean it by soft cleaning brush or cloth. Recommend to rinse and dry them thoroughly after washing, in order to keep them not discolor and stay in peak condition.

Grinding Worm(A), Grinding Body (B), Locking Ring(E), and Cleaning Brush.

Remark: This Food Grinder Attachment is designed for KitchenAid Stand Mixers, but not a Kitchenaid brand, KitchenAid is registered trademarks of their respective owners and are not endorsing, sponsoring or associated with KitchenAid.

To Attach Stand Mixer Attachment

Before Attaching Stand Mixer Attachment

1. Turn Stand Mixer speed control to OFF.
2. Unplug mixer or disconnect power.
3. Loosen the attachment knob(A) by turning it counterclockwise.
4. Remove the attachment hub cover or flip up hub cover.
5. Insert the attachment shaft housing(B) into the attachment hub (C) making certain that attachment power shaft fits into square hub socket.
6. It may be necessary to rotate the attachment back and forth. When the attachment is in proper position, the pin on the attachment housing will fit into the notch on the hub rim
7. Tighten the attachment knob by turning it clockwise until that attachment is completely secured into mixer.

